

# High Performance Subwoofer **B 1801**



**Subwoofer in High - Performance - Bassreflex - Technologie. Dieser sehr kompakte 18"-Subwoofer besticht durch einfaches Handling, hoher Reichweite und Effizienz. M20 Flansch auf der Oberseite. Optional ist ein Frontdeckel mit Lenkrollen lieferbar.**

## PRODUCT SPECIFICATIONS

<b>Speaker Components</b>	18"
<b>Description</b>	High Performance Subwoofer
<b>Powerhandling</b> <small>AES / Peak</small>	800 Watt / 2400 Watt
<b>Impedance</b> <small>nominal</small>	8 $\Omega$
<b>SPL 1m</b> <small>1 Watt / Peak</small>	100 dB / 132 dB
<b>Usable Range</b>	45 Hz - 180 Hz
<b>Tuning Frequency</b> <small>Excursion minimum</small>	52 Hz
<b>Connectors</b>	2 x Neutrik Speakon 4-pol Coding: 1 +/- HiMid, 2 +/- Sub
<b>Handles</b>	2 x 3D handle
<b>Fittings</b>	M20 on top Wheelboard fittings
<b>Weight</b>	37,0 kg
<b>Size</b> <small>height x width x depth</small>	69,8 x 51,2 x 56,0 cm
<b>Order No.</b>	<b>01055</b>



Abnehmbares Rollenbrett für den einfachen Transport.

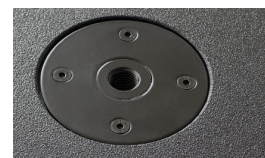

Die M20 Flanschplatte dient zur Aufnahme einer Verlängerungsstange für das HiHid.

## DIMENSIONS

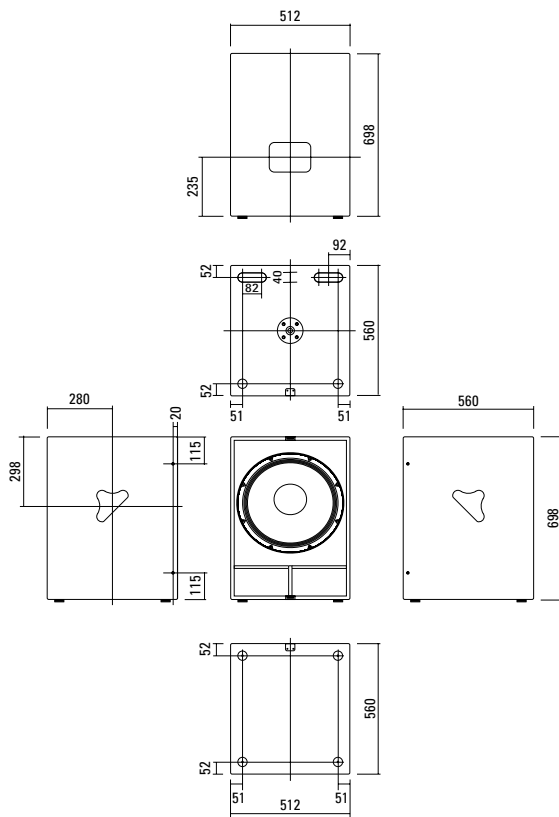

Controller Setups finden unter:

[www.seeburg.net/html/downloads\\_dt.html](http://www.seeburg.net/html/downloads_dt.html)

## MEASUREMENTS

Frequency Response

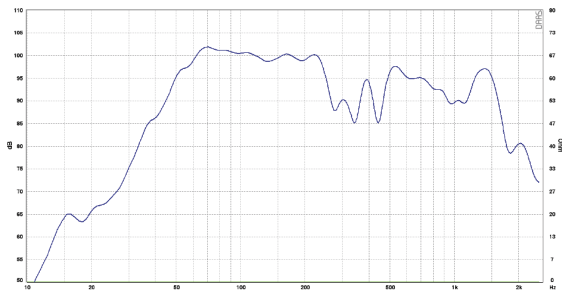

Impedance

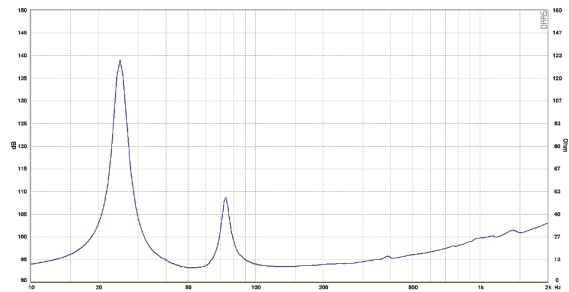

## ACCESSORIES B 1801

### Speaker Pole

M20, adjustable, K&M

Order No. **03022**



### Speaker Pole

M20, with wind up, K&M

Order No. **03023**



### Tilt Unit

with grid plate, 30 kg max.

Order No. **01282**



with grid plate and „balance correction“, 40 kg max.

Order No. **01284**

### Hybrid Cable System

PowerCon - PowerCon / XLR - XLR

5 m      Order No. **08464**

10 m     Order No. **08466**

15 m     Order No. **08468**



### Cover

for B 1801 by using wheelboard

Order No. **01252**



### Wheelboard

for B 1801, TSE-System / B 1801 / G Sub

Order No. **01260**



### Flightcase

for 2 x B 1801 units, heavy duty, 6,5 mm birch multiplex, PVC coated, ball corners, 6 x recessed sprung handles, 4 x butterfly catches, 100 mm blue wheels, 2 x with brake, interior lined with felt

Order No. **16034**